

Notes:  
Layout based upon UMC drawings: EMG2-UMC-SI-DR-A-0089-P5  
Illustrative Masterplan (revised 17/04/2025)

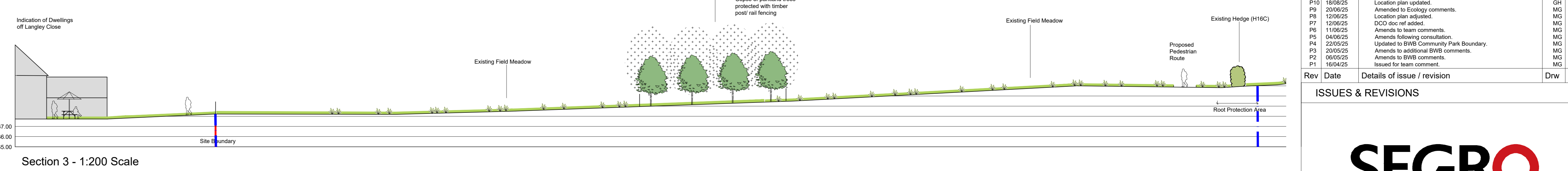
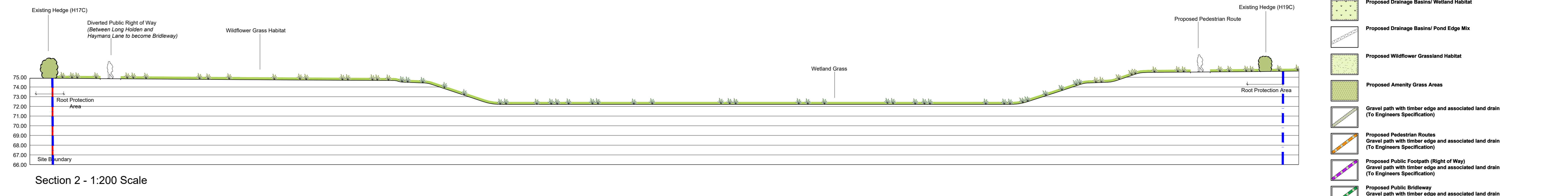
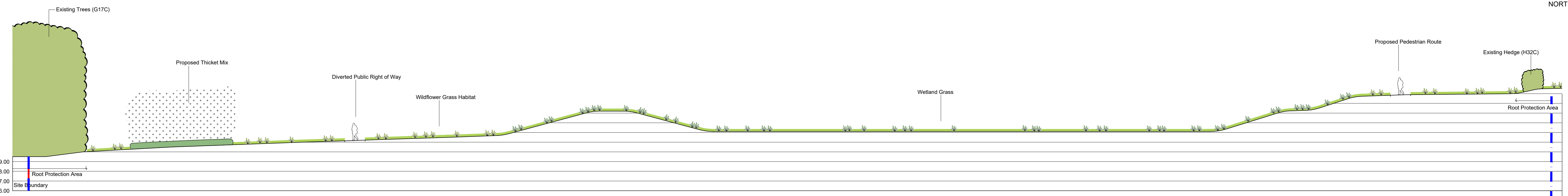
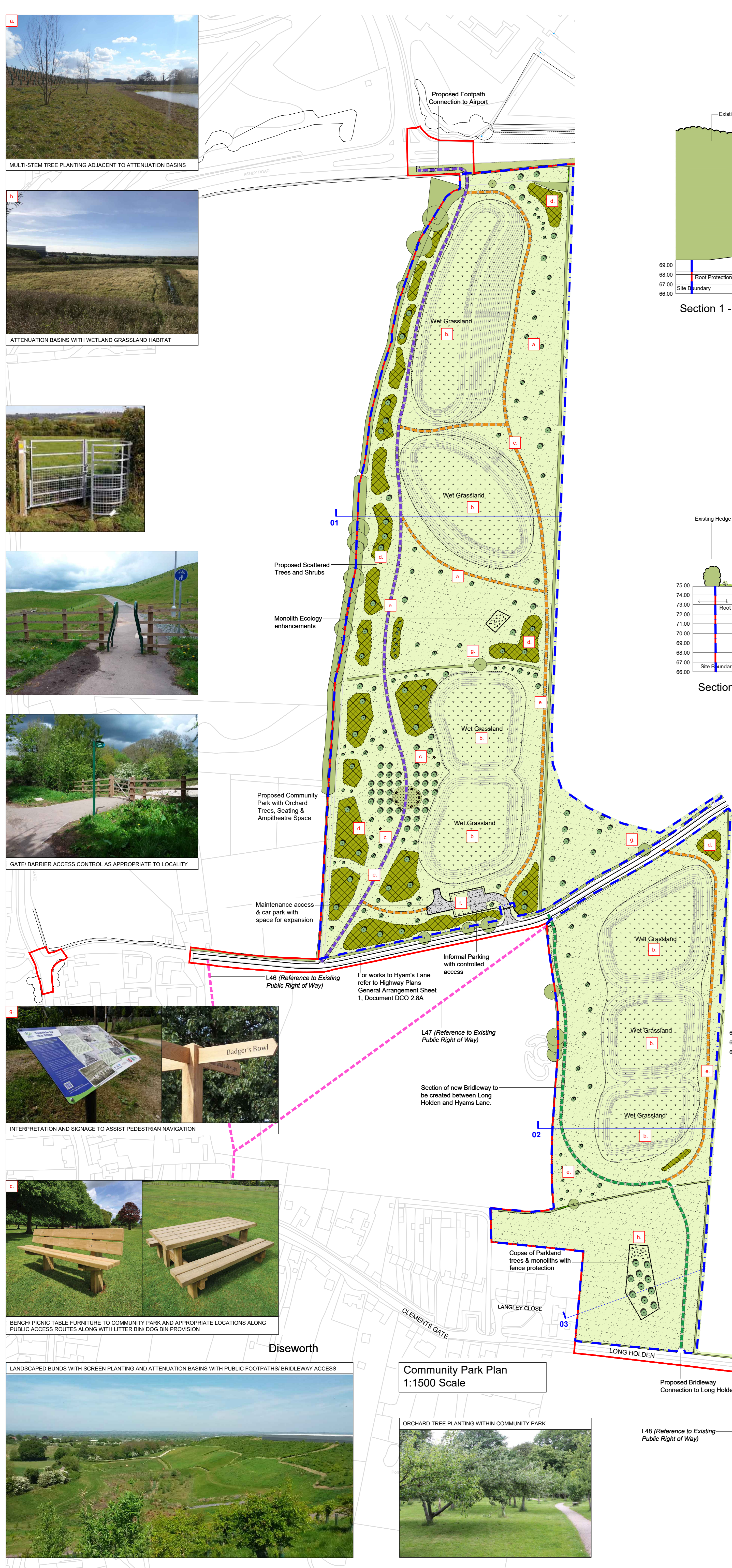
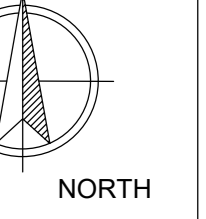

**Landscape Key**

- Existing Thicket Hedgerows to be retained (Refer to P12 for tree removal, retention & protection drawings)
- Semi Mature Trees (20-25cm stem girth)
- Extra Heavy Standard Trees (14-20cm stem girth)
- Multi-Stem Trees (3.5-4m height)
- Fastgrowing Trees (1.2-1.5m height)
- Proposed Thicket / Scrub Mix Planting (Transplants 600-800mm OG planted at 1m centres)
- Proposed Native Hedgerow (Transplants 600-800mm OG planted 2 rows 500mm apart at 450mm staggered centres)
- Proposed Drainage Basins/ Wetland Habitat
- Proposed Drainage Basins/ Pond Edge Mix
- Proposed Wetflower Grassland Habitat
- Proposed Amenity Grass Areas
- Gravel path with timber edge and associated land drain (To Engineers Specification)
- Proposed Pedestrian Routes (To Engineers Specification)
- Proposed Public Footpath (Right of Way) (To Engineers Specification)
- Proposed Public Bridleway (To Engineers Specification)
- Existing Public Right of Way (To Engineers Specification)
- CONTIGUOUS LEVELS (To Engineers Specification)
- Indicative Landscape Sections (Refer to Landscape Concept Section drawing number EMG2-BCA-ELS-XX-DR-L-2313-23-02 and 03)
- Community Park Boundary
- Site Boundary

Rev	Date	Details of issue / revision	Drw	Rev
P16	05/05/25	Additional path link added to BWB request.	MG	MG
P15	17/04/25	Amendment to landscape type measures.	MG	MG
P14	08/04/25	Addition of landscape type measures.	MG	MG
P13	03/10/25	Dig title revision.	MG	MG
P12	20/08/25	Updates to PROW annotation (Delta) and red line (BWB).	GH	GH
P11	19/08/25	Amended to BWB comment.	GH	GH
P10	18/08/25	Location plan updated.	MG	MG
P9	20/06/25	Amended to Ecology comments.	MG	MG
P8	12/06/25	Location plan updated.	MG	MG
P7	04/06/25	DCO spot ref added.	MG	MG
P6	11/06/25	Amended to team comments.	MG	MG
P5	04/06/25	Amended following consultation.	MG	MG
P4	22/05/25	Updated to BWB Community Park Boundary.	MG	MG
P3	20/05/25	Amended to additional BWB comments.	MG	MG
P2	06/05/25	Amended to BWB comments.	MG	MG
P1	16/04/25	Issued for team comment.	MG	MG

**ISSUES & REVISIONS**



**THE EAST MIDLANDS GATEWAY PHASE 2 AND HIGHWAY ORDER 202[ ]**

**COMMUNITY PARK PLAN**

Scale	1:1500	Drawn	MG
Size	AO	Reviewed	MG
Regulation	5(2) (o)	Document	DCO 2.16
Drawing Status	<b>DCO SUBMISSION</b>		
Drawing No.	EMG2-BCA-ELS-XX-DR-L-2313-23-17-S5	Revision	<b>P16</b>

**LANDSCAPE TYPOLOGIES WITHIN COMMUNITY PARK**

	m <sup>2</sup>	Hectare
General Wetflower	79,497 m <sup>2</sup>	7.9497 ha
Thicket Planting	10,981 m <sup>2</sup>	1.0981 ha
Proposed Informal Parking	832 m <sup>2</sup>	0.0832 ha
Fenced off Monolith Areas	1,216 m <sup>2</sup>	0.1216 ha

